

ALL BALUSTRADES MANUFACTURED BY A.M.I. COMPLY TO CURRENT BUILDING REGULATIONS OR AS INSTRUCTED BY THE CLIENTS ARCHITECT.

A.M.I. STAIRS & BALUSTRADES WILL TYPICALLY COMPLY WITH APPROVED DOCUMENT "K" OR "M" FROM THE BUILDING REGULATIONS AND B.S. 6180:2011. BALUSTRADES WILL ADHERE TO D.D.A. RULES WHEN SPECIFIED.

IF NO APPLICATION OR LOAD IS SPECIFIED THEN AN APPROPRIATE LOAD CASE WILL BE SELECTED FROM B.S.6399-1:1996 TABLE 4. STRUCTURAL CALCULATIONS CAN BE SUPPLIED ON REQUEST.

TYPICALLY HEIGHTS OF BALUSTRADE RANGE FROM 900 TO 1000 ON THE STAIR FLIGHTS MEASURED VERTICALLY FROM THE TREAD NOSING TO THE TOP OF THE HAND RAIL. LANDING BALUSTRADE HEIGHTS TYPICALLY RANGE FROM 1000 TO 1100 FROM FINISHED FLOOR LEVEL TO TOP OF HAND RAIL. A.M.I. RECOMMEND THE LANDINGS BALUSTRADE HEIGHTS TO BE AT THE MAXIMUM OF 1100 AS GOOD PRACTICE. DIAMETER OF HAND RAIL DEPENDS ON WHETHER THE STAIR IS REQUIRED FOR DISABLED USE & LOADS APPLIED.

BALUSTRADE HEIGHTS ON LOW PARAPET WALLS WILL BE TAKEN AS 1100 FROM TOP OF WALL NOT FINISHED FLOOR LEVEL UNLESS INSTRUCTED OTHERWISE.

- TYPICAL MATERIALS**
- MILD STEEL**
- BALUSTERS** = 48.3Ø*3.2 C.H.S.
- SPIGOT** = 16Ø SOLID BAR
- BASE FIXINGS** = 2-33.7Ø*3.2 C.H.S.
- = 2-21.3Ø*3.2 C.H.S.
- FIXINGS** = 2-M12Ø RESIN ANCHOR BOLTS
- STAINLESS STEEL**
- TOP RAIL** = 42.4Ø*2.6 C.H.S

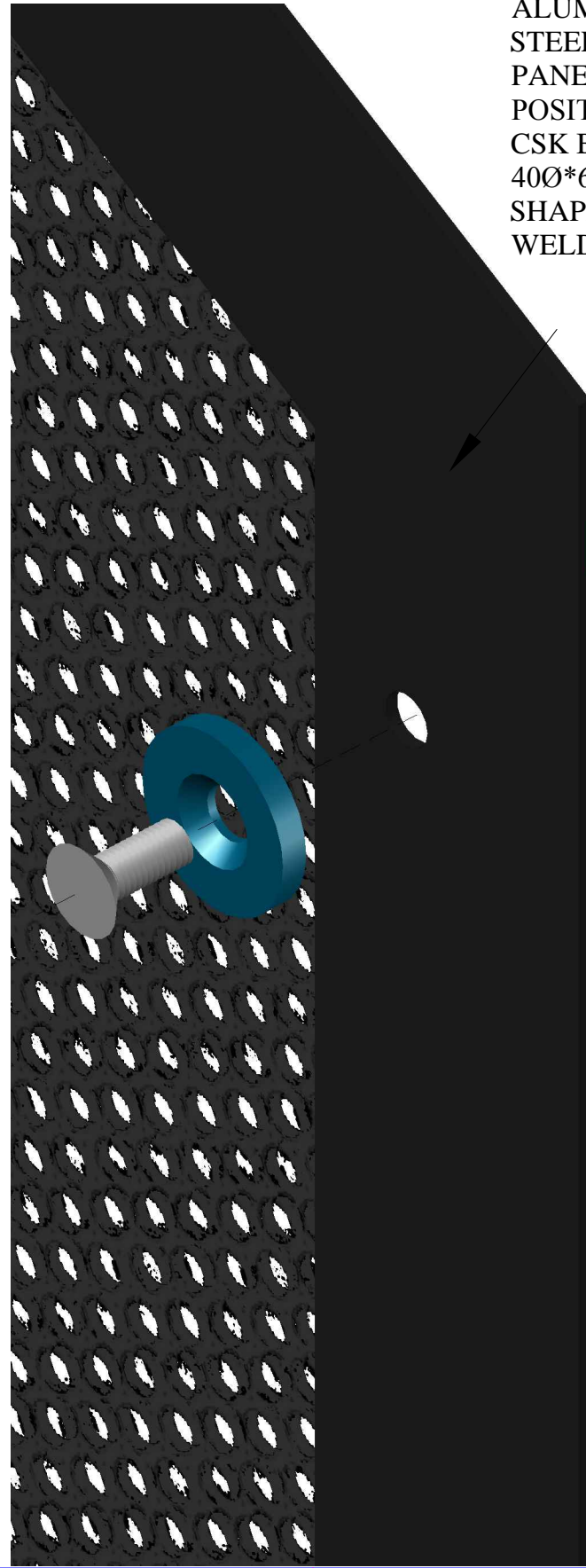

ALUMINIUM OR MILD STEEL PERFORATED PANEL HELD IN POSITION WITH 1-M10Ø CSK BOLT THROUGH 40Ø*6 WASHER PLT & SHAPED 40*6 FLT BRKT WELDED TO POST.

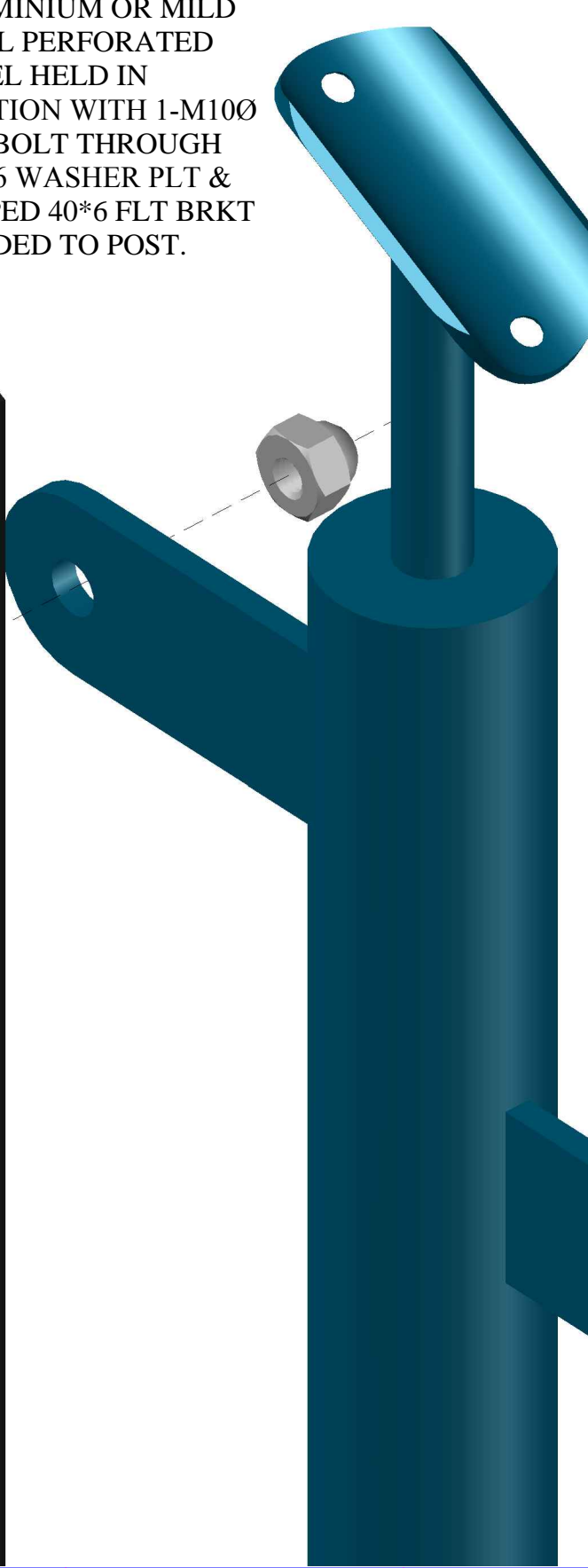

2-33.7Ø*3.2 C.H.S. BOSS WELDED TO BALUSTER

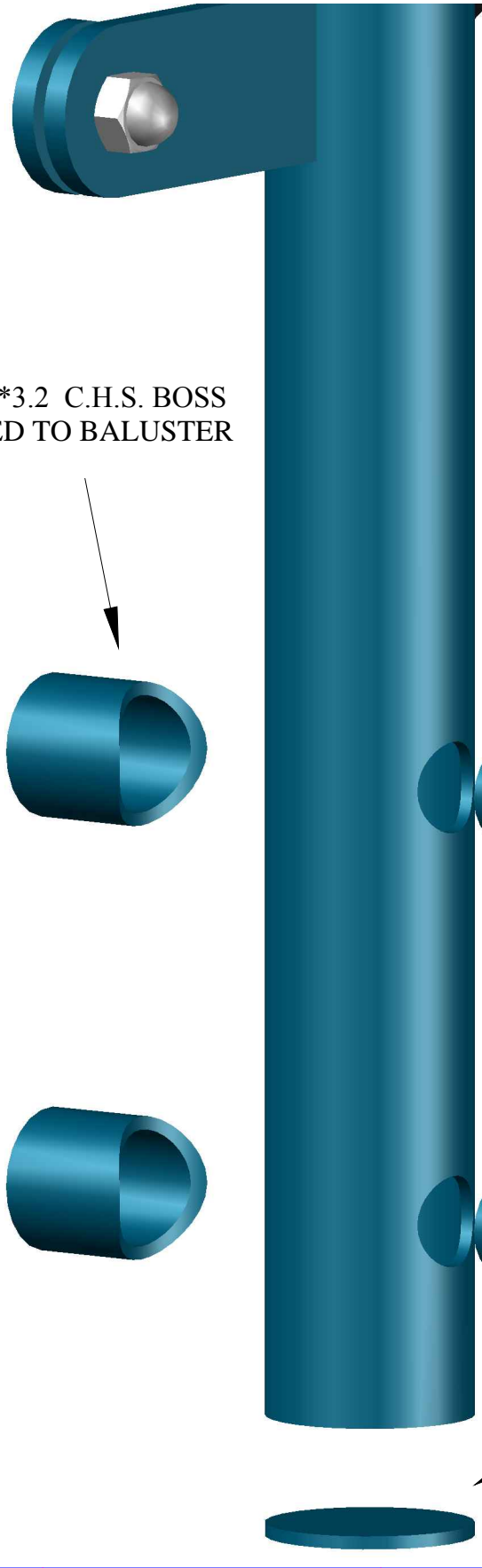

2-21.3Ø*3.2 C.H.S. SPACERS WELDED INTO BALUSTER TO WITHSTAND CRUSHING EFFECT OF BOLTS.

35Ø SOLID BAR MILLED TO BALUSTER PROFILE, DRILLED TO SUIT BOLT.

2-M12Ø (TYPICAL) RESIN ANCHOR STUDS SET INTO CONCRETE STAIR. BALUSTRADE SECURED TO STUDS WITH 2-M12Ø DOMED NUTS.

1-M12Ø WASHER TO EACH FIXING.

48Ø*3 CAP PLT WELDED TO BASE OF BALUSTERS IN SHOP.

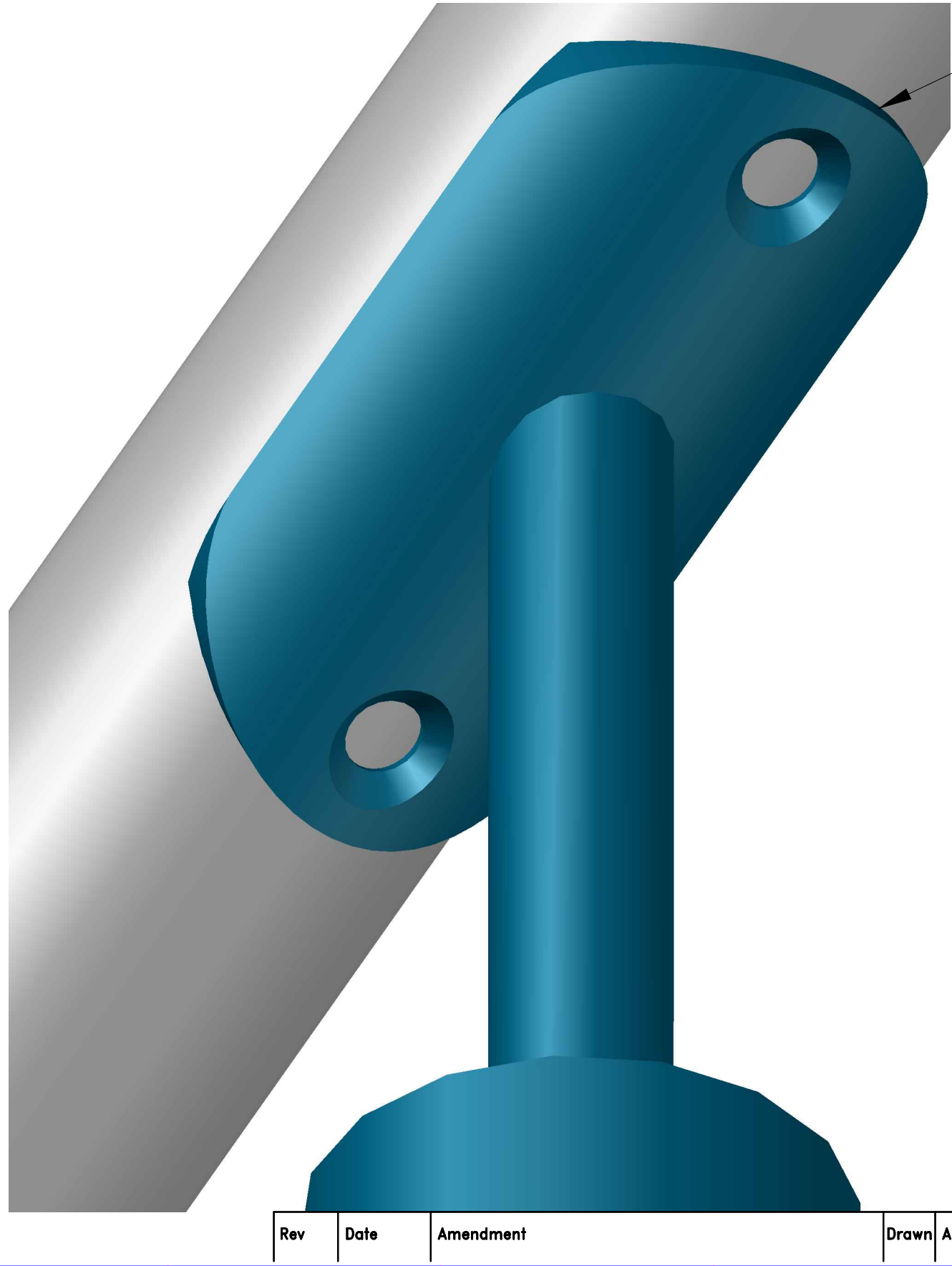

MILD STEEL SADDLE SHOP WELDED TO 16Ø BAR SPIGOT (TYPICAL) IN SHOP PRIOR TO APPLIED FINISHES. STAINLESS TOP RAIL SECURED TO SADDLE ON SITE. M6Ø FIXINGS DRILLED AND TAPPED.

A.M.I.

Unit 12a, Hunter Park,
Callywhite Lane,
Dronfield, S18 2XP
Tel: 01246 413378
Fax: 01246 414494
Email: info@ami-sheffield.co.uk

CLIENT

PROJECT

DRAWING TITLE

NEPTUNE
BALUSTRADE DETAILS

DRAWN BY

CHECKED BY

DATE

SCALE

PROJECT No.

DRAWING No.

REV

Rev

Date

Amendment

Drawn

App